

Update VBIOS SOP

[Step 0.] Set environment before update VBIOS.

1. Please plug in AC adapter.
2. Upgrade system BIOS to latest version.

[Step 1.] Execute Jimny_RBH_Ignis_RBH_VBIOS_V100a.bat

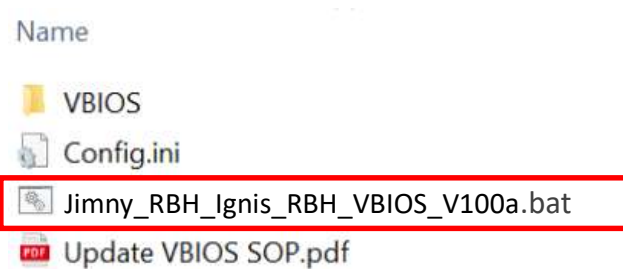

[Step 2.] Allow this app.

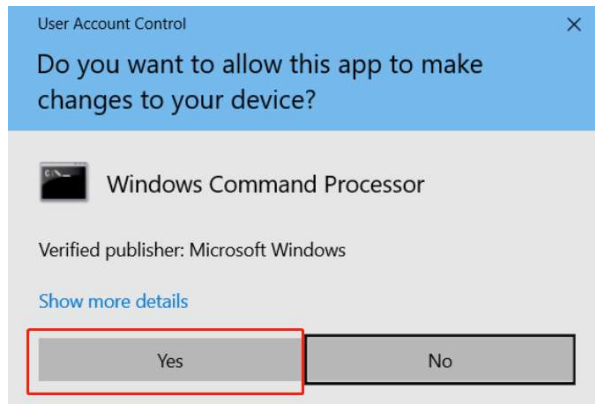

[Step 3.] Show update successful message.

```
Command Prompt
NVIDIA Firmware Update Utility
Version 5.687.0
Copyright (C) 2018-2020, NVIDIA Corporation. All rights reserved.

The display may go *BLANK* on and off for up to 6 seconds
or more during access to the EEPROM depending on your display
adapter and output device, it will begin in about 3 seconds.

Firmware Image Version: 94.06.0F.00.B1
Found display adapter suitable for this update:
GeForce RTX 3060 Laptop GPU Device Path: S:00,B:01,D:00,F:00
Current Firmware Version: 94.06.19.00.5F

UPDATE WILL BEGIN IN ABOUT 3 SECONDS.

[=====] 100 %
Main firmware range does not match a protectable range.
Update successful.
Firmware image has been updated from version 94.06.19.00.5F to 94.06.0F.00.B1.

A restart is required for the new firmware to take effect.

Press any key to continue . . .
```

[Step 4.] Restart your computer.

(NOTE: Reminding to save your data of running before restart)

Fail Message

[Fail] This tool does NOT support this project.

```
C:\Windows\system32\cmd.exe

=====
Update VBIOS Utility                                     V1.01
Author : Dept. SW3
Copyright 2021 (c) COMPAL ELECTRONICS INC. All rights reserved .
=====
Loading Config...
Loading Device Settings...

Waiting for 0 seconds, press a key to continue ...

Waiting for 0 seconds, press a key to continue ...
Checking Project
Fail: This tool does NOT support this project.(SSID:0x151F1025)
Press any key to continue . . .
```

[Fail] The VBIOS update file does NOT support your graphic card.

```
C:\Windows\system32\cmd.exe

=====
Update VBIOS Utility                                     V1.01
Author : Dept. SW3
Copyright 2021 (c) COMPAL ELECTRONICS INC. All rights reserved .
=====
Loading Config...
Loading Device Settings...

Waiting for 0 seconds, press a key to continue ...

Waiting for 0 seconds, press a key to continue ...
Checking Project...
Checking dGPU and VBIOS version...
Fail: This VBIOS update file does NOT support your graphic card.(DeviceID:0x249C10DE)
Press any key to continue . . .
```

[Fail] This VBIOS version has been installed.

```
C:\Windows\system32\cmd.exe

=====
Update VBIOS Utility                                     V1.01
Author : Dept. SW3
Copyright 2021 (c) COMPAL ELECTRONICS INC. All rights reserved .
=====
Loading Config...
Loading Device Settings...

Waiting for 0 seconds, press a key to continue ...

Waiting for 0 seconds, press a key to continue ...
Checking Project...
Checking dGPU and VBIOS version
Fail: This VBIOS version 94.04.35.00.33 has been installed.
Press any key to continue . . .
```